

SUSPENSION PIN/BUSHING ASSEMBLY

Features

- Rugged crimped construction
- High load capacity
- Tight tolerance
- High-compression elastomer

Benefits

- Eliminates need for lubrication
- Extra long service life
- Withstands high impact shock and $\pm 7^\circ$ torsional rotation
- Provides vibration, shock and noise attenuation

Load Range

- 2,000 lbs. to 4,500 lbs. per pin

Significantly extends service life of suspension components in vehicular applications.



Barry Suspension Pin/Bushing Assembly is designed and constructed for maintenance free and consistent service life. These superior parts will outlast the predicted life of modern heavy-duty leaf spring suspension in vehicular applications.

Applications

- Medium & Heavy-Duty Truck/
Tractor Front & Rear Suspension
Assemblies

RESILIENT ELEMENT	Natural Rubber
STANDARD MATERIALS	High Strength Steel
WEIGHT	2.5 lbs.

Environmental Data

- Natural Rubber elastomer has an operating temperature range of -25°F to $+160^\circ\text{F}$ (-30°C to $+70^\circ\text{C}$)

Suspension Pin/Bushing Assembly

Dimensions & Performance Characteristics

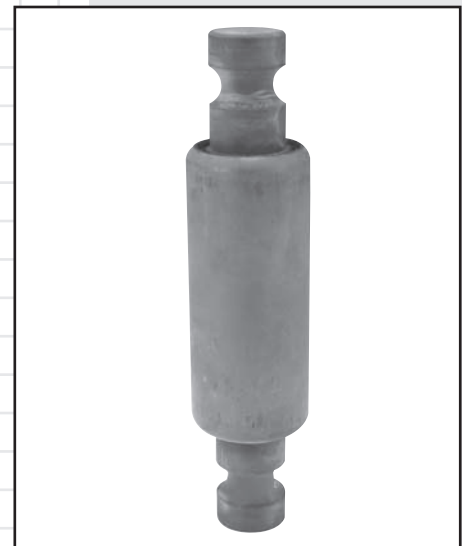
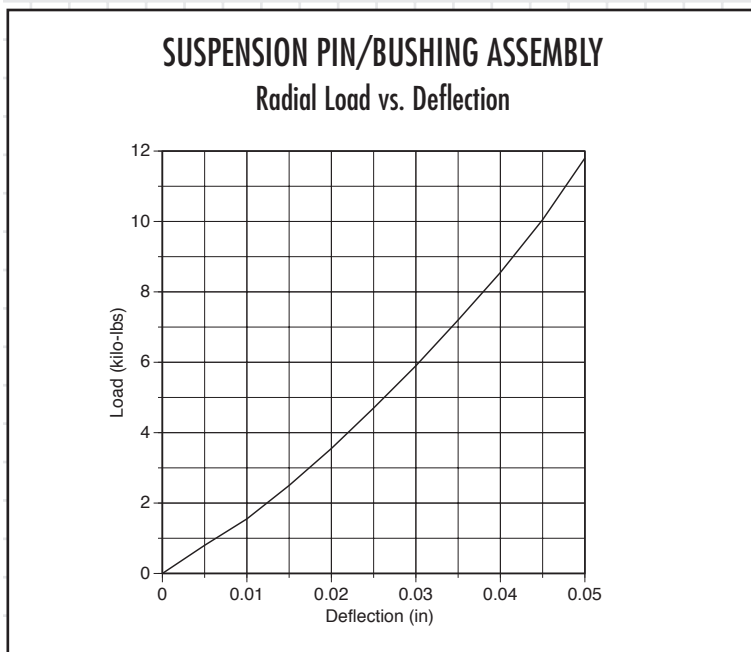
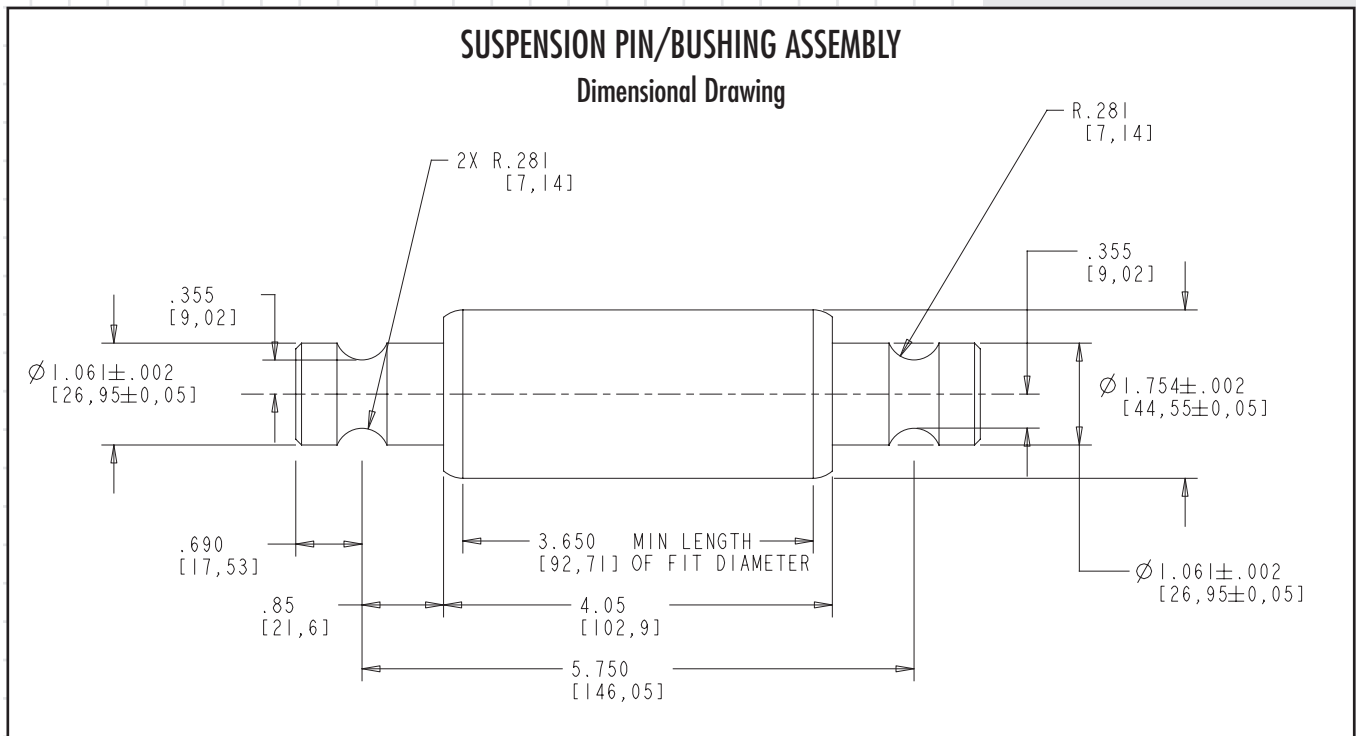

For more information contact:

BLACK DIAMOND
Products

5058 Cedar Ridges Lane RR#1

Inverary, ON K0H-1X0

P: 613-544-2002

F: 613-544-2003

www.bdproduct.ca